

## F

## E

- D

## C

- B

## A

- 2

## 3

- 4

▲

4

5

6

7

3

●

•

1

1

2

## 1

ISSUE FOR APPROVAL

[www.dialbeforeyoudig.com.au](http://www.dialbeforeyoudig.com.au)

 **DIAL  
BEFORE YOU DIG**

**NASTASI & ASSOCIATES**  
CONSULTING CIVIL & STRUCTURAL ENGINEERS  
B.E., M.I.E. AUST. CPENG NPER-3

UNIT 5, 1-3 WHYALLA PLACE, PRESTONS NSW 2170  
PH: (02) 9607 2864 OR (02) 8798 5617 FAX: (02) 9731 2081  
MOB: 0419 041 401

QUALITY CONTROL

PAWN DATE

CHECKED \_\_\_\_\_ DATE \_\_\_\_\_

APPROVED:

CLIENT:

PROJECT:

TITLE:

COVER SHEET &amp; NOTES

DRAWING STATUS  
CONCEPT PLAN FOR APPROVAL

SCALE ( AT ORIGINAL SIZE)

AS NOTED

PROJECT NO.

DRAWING NO.

REVISION NO



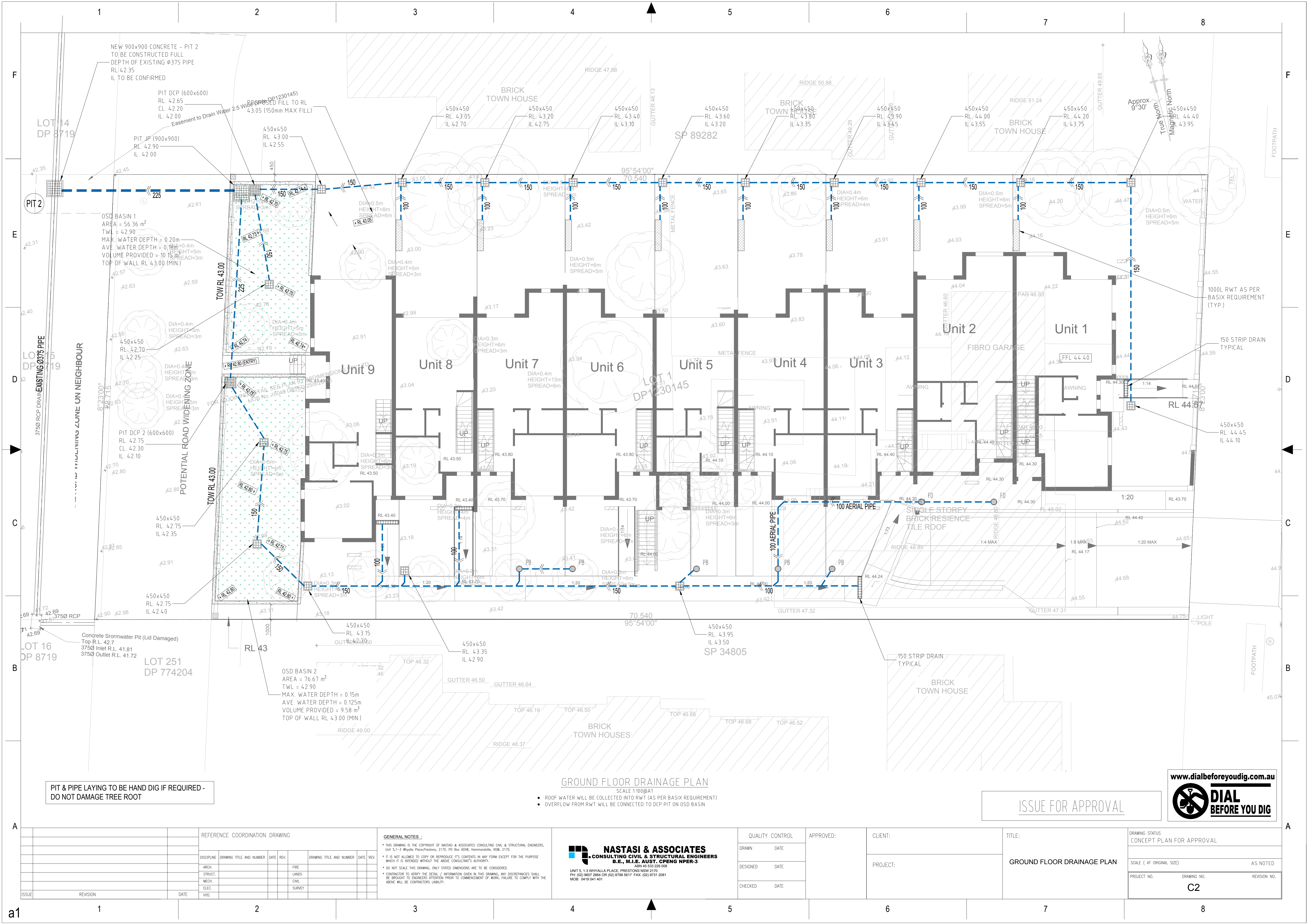



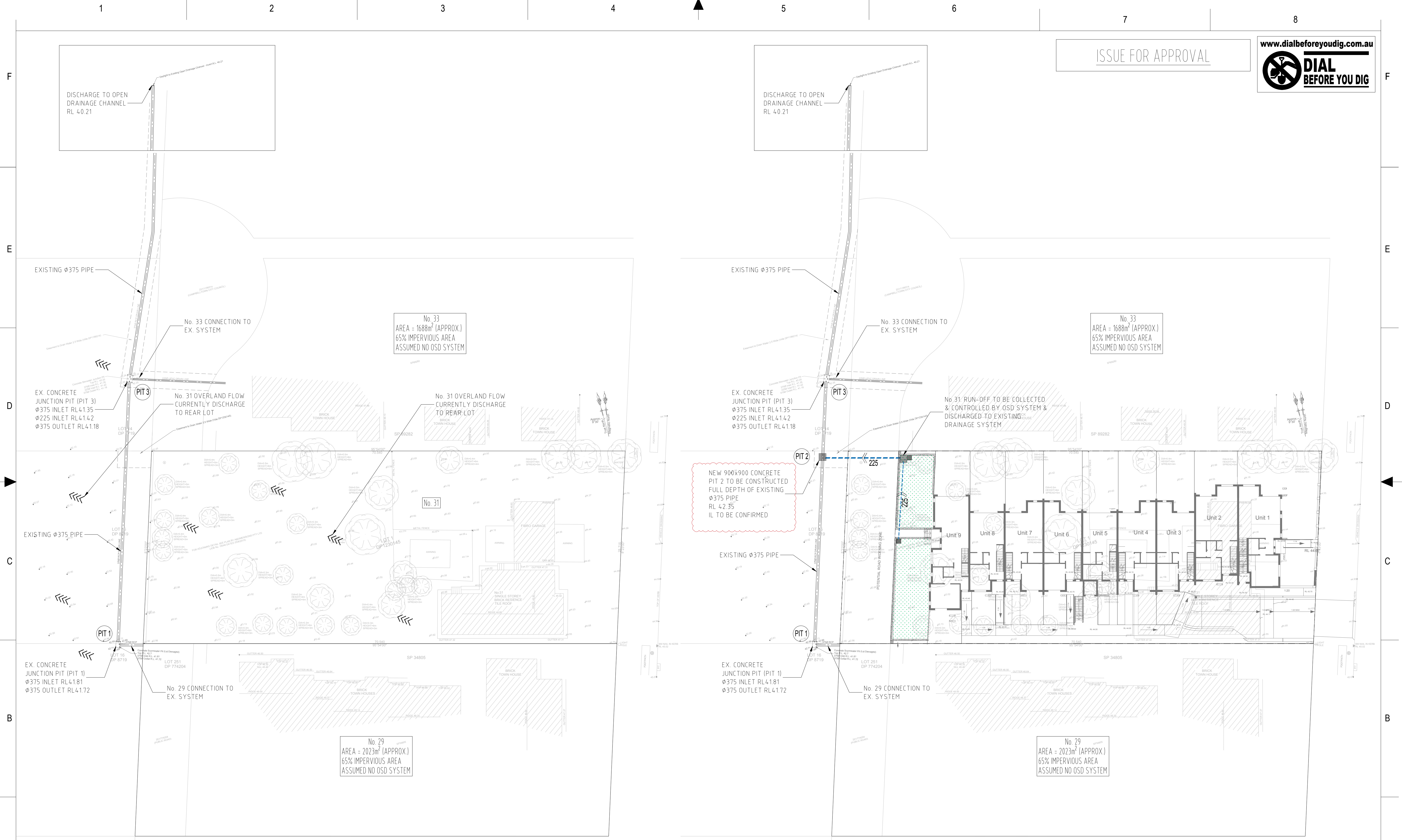

ISSUE FOR APPROVAL



EXISTING STORMWATER SYSTEM  
SCALE 1:250

PROPOSED STORMWATER SYSTEM  
SCALE 1:250

		REFERENCE COORDINATION DRAWING										<div>GENERAL NOTES :</div> <div><ul style="list-style-type: none"><li>THIS DRAWING IS THE COPYRIGHT OF NASTASI &amp; ASSOCIATES CONSULTING CIVIL &amp; STRUCTURAL ENGINEERS, Unit 5.1-5 Whyalla Place, Prestons, 2170, PO Box 6048, Hammondville, NSW, 2170.</li><li>IT IS NOT ALLOWED TO COPY OR REPRODUCE IT'S CONTENTS IN ANY FORM EXCEPT FOR THE PURPOSE WHICH IT IS INTENDED WITHOUT THE ABOVE CONSULTANTS AUTHORITY.</li><li>DO NOT SCALE THIS DRAWING, ONLY STATED DIMENSIONS ARE TO BE CONSIDERED.</li><li>CONTRACTOR TO VERIFY THE DETAIL / INFORMATION GIVEN IN THIS DRAWING, ANY DISCREPANCIES SHALL BE BROUGHT TO ENGINEERS ATTENTION PRIOR TO COMMENCEMENT OF WORK, FAILURE TO COMPLY WITH THE ABOVE WILL BE CONTRACTORS LIABILITY.</li></ul></div>										<div><div><div><div></div><div></div><div></div></div><div><div></div><div></div><div></div></div></div><div><div><div></div><div></div><div></div></div><div><div></div><div></div><div></div></div></div><div><div><div></div><div></div><div></div></div><div><div></div><div></div><div></div></div></div></div> <div><div><div></div><div></div><div></div></div><div><div></div><div></div><div></div></div></div> <div><div><div></div><div></div><div></div></div><div><div></div><div></div><div></div></div></div> <div><div><div></div><div></div><div></div></div><div><div></div><div></div><div></div></div></div> <div><div><div></div><div></div><div></div></div><div><div></div><div></div><div></div></div></div> <div><div><div></div><div></div><div></div></div><div><div></div><div></div><div></div></div></div> <div><div><div></div><div></div><div></div></div><div><div></div><div></div><div></div></div></div> <div><div><div></div><div></div><div></div></div><div><div></div><div></div><div></div></div></div> <div><div><div></div><div></div><div></div></div><div><div></div><div></div><div></div></div></div> <div><div><div></div><div></div><div></div></div><div><div></div><div></div><div></div></div></div> <div><div><div></div><div></div><div></div></div><div><div></div><div></div><div></div></div></div> <div><div><div></div><div></div><div></div></div><div><div></div><div></div><div></div></div></div> <div><div><div></div><div></div><div></div></div><div><div></div><div></div><div></div></div></div> <div><div><div></div><div></div><div></div></div><div><div></div><div></div><div></div></div></div> <div><div><div></div><div></div><div></div></div><div><div></div><div></div><div></div></div></div> <div><div><div></div><div></div><div></div></div><div><div></div><div></div><div></div></div></div> <div><div><div></div><div></div><div></div></div><div><div></div><div></div><div></div></div></div> <div><div><div></div><div></div><div></div></div><div><div></div><div></div><div></div></div></div> <div><div><div></div><div></div><div></div></div><div><div></div><div></div><div></div></div></div> <div><div><div></div><div></div><div></div></div><div><div></div><div></div><div></div></div></div> <div><div><div></div><div></div><div></div></div><div><div></div><div></div><div></div></div></div> <div><div><div></div><div></div><div></div></div><div><div></div><div></div><div></div></div></div> <div><div><div></div><div></div><div></div></div><div><div></div><div></div><div></div></div></div> <div><div><div></div><div></div><div></div></div><div><div></div><div></div><div></div></div></div> <div><div><div></div><div></div><div></div></div><div><div></div><div></div><div></div></div></div> <div><div><div></div><div></div><div></div></div><div><div></div><div></div><div></div></div></div> <div><div><div></div><div></div><div></div></div><div><div></div><div></div><div></div></div></div> <div><div><div></div><div></div><div></div></div><div><div></div><div></div><div></div></div></div> <div><div><div></div><div></div><div></div></div><div><div></div><div></div><div></div></div></div> <div><div><div></div><div></div><div></div></div><div><div></div><div></div><div></div></div></div> <div><div><div></div><div></div><div></div></div><div><div></div><div></div><div></div></div></div> <div><div><div></div><div></div><div></div></div><div><div></div><div></div><div></div></div></div> <div><div><div></div><div></div><div></div></div><div><div></div><div></div><div></div></div></div> <div><div><div></div><div></div><div></div></div><div><div></div><div></div><div></div></div></div> <div><div><div></div><div></div><div></div></div><div><div></div><div></div><div></div></div></div> <div><div><div></div><div></div><div></div></div><div><div></div><div></div><div></div></div></div> <div><div><div></div><div></div><div></div></div><div><div></div><div></div><div></div></div></div> <div><div><div></div><div></div><div></div></div><div><div></div><div></div><div></div></div></div> <div><div><div></div><div></div><div></div></div><div><div></div><div></div><div></div></div></div> <div><div><div></div><div></div><div></div></div><div><div></div><div></div><div></div></div></div> <div><div><div></div><div></div><div></div></div><div><div></div><div></div><div></div></div></div> <div><div><div></div><div></div><div></div></div><div><div></div><div></div><div></div></div></div> <div><div><div></div><div></div><div></div></div><div><div></div><div></div><div></div></div></div> <div><div><div></div><div></div><div></div></div><div><div></div><div></div><div></div></div></div> <div><div><div></div><div></div><div></div></div><div><div></div><div></div><div></div></div></div> <div><div><div></div><div></div><div></div></div><div><div></div><div></div><div></div></div></div> <div><div><div></div><div></div><div></div></div><div><div></div><div></div><div></div></div></div> <div><div><div></div><div></div><div></div></div><div><div></div><div></div><div></div></div></div> <div><div><div></div><div></div><div></div></div><div><div></div><div></div><div></div></div></div> <div><div><div></div><div></div><div></div></div><div><div></div><div></div><div></div></div></div> <div><div><div></div><div></div><div></div></div><div><div></div><div></div><div></div></div></div> <div><div><div></div><div></div><div></div></div><div><div></div><div></div><div></div></div></div> <div><div><div></div><div></div><div></div></div><div><div></div><div></div><div></div></div></div> <div><div><div></div><div></div><div></div></div><div><div></div><div></div><div></div></div></div> <div><div><div></div><div></div><div></div></div><div><div></div><div></div><div></div></div></div> <div><div><div></div><div></div><div></div></div><div><div></div><div></div><div></div></div></div> <div><div><div></div><div></div><div></div></div><div><div></div><div></div><div></div></div></div> <div><div><div></div><div></div><div></div></div><div><div></div><div></div><div></div></div></div> <div><div><div></div><div></div><div></div></div><div><div></div><div></div><div></div></div></div> <div><div><div></div><div></div><div></div></div><div><div></div><div></div><div></div></div></div> <div><div><div></div><div></div><div></div></div><div><div></div><div></div><div></div></div></div> <div><div><div></div><div></div><div></div></div><div><div></div><div></div><div></div></div></div> <div><div><div></div><div></div><div></div></div><div><div></div><div></div><div></div></div></div> <div><div><div></div><div></div><div></div></div><div><div></div><div></div><div></div></div></div> <div><div><div></div><div></div><div></div></div><div><div></div><div></div><div></div></div></div> <div><div><div></div><div></div><div></div></div><div><div></div><div></div><div></div></div></div> <div><div><div></div><div></div><div></div></div><div><div></div><div></div><div></div></div></div> <div><div><div></div><div></div><div></div></div><div><div></div><div></div><div></div></div></div> <div><div><div></div><div></div><div></div></div><div><div></div><div></div><div></div></div></div> <div><div><div></div><div></div><div></div></div><div><div></div><div></div><div></div></div></div> <div><div><div></div><div></div><div></div></div><div><div></div><div></div><div></div></div></div> <div><div><div></div><div></div><div></div></div><div><div></div><div></div><div></div></div></div> <div><div><div></div><div></div><div></div></div><div><div></div><div></div><div></div></div></div> <div><div><div></div><div></div><div></div></div><div><div></div><div></div><div></div></div></div> <div><div><div></div><div></div><div></div></div><div><div></div><div></div><div></div></div></div> <div><div><div></div><div></div><div></div></div><div><div></div><div></div><div></div></div></div> <div><div><div></div><div></div><div></div></div><div><div></div><div></div><div></div></div></div> <div><div><div></div><div></div><div></div></div><div><div></div><div></div><div></div></div></div> <div><div><div></div><div></div><div></div></div><div><div></div><div></div><div></div></div></div> <div><div><div></div><div></div><div></div></div><div><div></div><div></div><div></div></div></div> <div><div><div></div><div></div><div></div></div><div><div></div><div></div><div></div></div></div> <div><div><div></div><div></div><div></div></div><div><div></div><div></div><div></div></div></div> <div><div><div></div><div></div><div></div></div><div><div></div><div></div><div></div></div></div> <div><div><div></div><div></div><div></div></div><div><div></div><div></div><div></div></div></div> <div><div><div></div><div></div><div></div></div><div><div></div><div></div><div></div></div></div> <div><div><div></div><div></div><div></div></div><div><div></div><div></div><div></div></div></div> <div><div><div></div><div></div><div></div></div><div><div></div><div></div><div></div></div></div> <div><div><div></div><div></div><div></div></div><div><div></div><div></div><div></div></div></div> <div><div><div></div><div></div><div></div></div><div><div></div><div></div><div></div></div></div> <div><div><div></div><div></div><div></div></div><div><div></div><div></div><div></div></div></div> <div><div><div></div><div></div><div></div></div><div><div></div><div></div><div></div></div></div> <div><div><div></div><div></div><div></div></div><div><div></div><div></div><div></div></div></div> <div><div><div></div><div></div><div></div></div><div><div></div><div></div><div></div></div></div> <div><div><div></div><div></div><div></div></div><div><div></div><div></div><div></div></div></div> <div><div><div></div><div></div><div></div></div><div><div></div><div></div><div></div></div></div> <div><div><div></div><div></div><div></div></div><div><div></div><div></div><div></div></div></div> <div><div><div></div><div></div><div></div></div><div><div></div><div></div><div></div></div></div> <div><div><div></div><div></div><div></div></div><div><div></div><div></div><div></div></div></div> <div><div><div></div><div></div><div></div></div><div><div></div><div></div><div></div></div></div> <div><div><div></div><div></div><div></div></div><div><div></div><div></div><div></div></div></div> <div><div><div></div><div></div><div></div></div><div><div></div><div></div><div></div></div></div> <div><div><div></div><div></div><div></div></div><div><div></div><div></div><div></div></div></div> <div><div><div></div><div></div><div></div></div><div><div></div><div></div><div></div></div></div> <div><div><div></div><div></div><div></div></div><div><div></div><div></div><div></div></div></div> <div><div><div></div><div></div><div></div></div><div><div></div><div></div><div></div></div></div> <div><div><div></div><div></div><div></div></div><div><div></div><div></div><div></div></div></div> <div><div><div></div><div></div><div></div></div><div><div></div><div></div><div></div></div></div> <div><div><div></div><div></div><div></div></div><div><div></div><div></div><div></div></div></div> <div><div><div></div><div></div><div></div></div><div><div></div><div></div><div></div></div></div> <div><div></div></div>									
--	--	--------------------------------	--	--	--	--	--	--	--	--	--	--	--	--	--	--	--	--	--	--	--	---	--	--	--	--	--	--	--	--	--

**NASTASI & ASSOCIATES**  
CONSULTING CIVIL & STRUCTURAL ENGINEERS  
B.E., M.I.E. AUST. CPENG NPER-3  
ABN 45 633 226 008  
UNIT 5, 1-3 WHYALLA PLACE, PRESTONS NSW 2170  
PH: (02) 9607 2864 OR (02) 9798 9617 FAX: (02) 9731 2081  
MOB: 0419 041 401



F

E

D

C

B

A

a1



EXISTING STORMWATER SYSTEM  
SCALE 1:500

DESIGN SUMMARY

- EXISTING REAR DRAINAGE SYSTEM**
- DISCHARGED TO OPEN CHANNEL
  - Ø375 MAIN CONCRETE PIPE
  - No. 29 & 33 CONNECTED TO EXISTING SYSTEM VIA CONCRETE JUNCTION PIT
  - No. 31 RUN-OFF CURRENTLY FLOWS TO PEMBROKE ROAD WITHOUT CONNECTED TO EXISTING SYSTEM
- REFER TO SURVEY PLAN BY ROSS ALBERT ROBINSON DATED 29/08/2019, DRAWING No 19105-1-A.
- PROPOSED DRAINAGE SYSTEM**
- PROPOSE NEW 900SOR CONCRETE PIT 2 TO FULL DEPTH OF EXISTING PIPE
  - No. 31 RUN-OFF TO BE COLLECTED, CONTROLLED AND DISCHARGED TO PIT 2
  - ILSAX - DRAINS MODEL TO ENSURE NO IMPACT/INCREASE IN OVERLAND FLOW DUE TO THIS DEVELOPMENT.
- DRAINS MODEL**
- ASSUMED NO OSD ON No. 29 BLACKWOOD (65% IMPERVIOUS AREA)
  - ASSUMED NO OSD ON No. 33 BLACKWOOD (65% IMPERVIOUS AREA)
  - No. 31 BLACKWOOD CURRENTLY OVERFLOW TO REAR LOT (NO CONTROL)
  - 50% PIPE & PIT BLOCKAGE
- RESULTS**
- NO EXTRA SURCHARGE ON EXISTING PIT 1 & 3
  - EXISTING DRAINAGE SYSTEM CAPACITY IS SUFFICIENT FOR THIS DEVELOPMENT
  - OSD BASIN 1 VOLUME REQUIRED = 3.70m<sup>3</sup>
  - OSD BASIN 2 VOLUME REQUIRED = 5.71m<sup>3</sup>
  - OSD VOLUME PROVIDED = 10.15m<sup>3</sup> + 9.58m<sup>3</sup> = 19.73m<sup>3</sup>
  - ORIFICE DIAMETER = 130mm

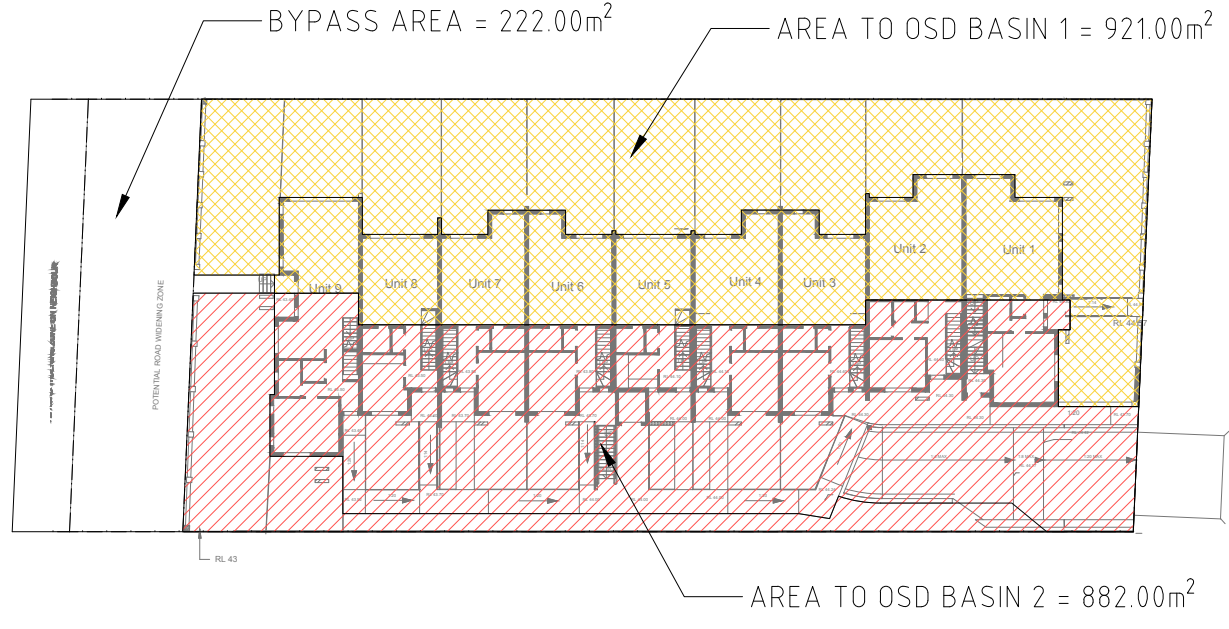

OSD CATCHMENT AREA PLAN  
SCALE 1:500

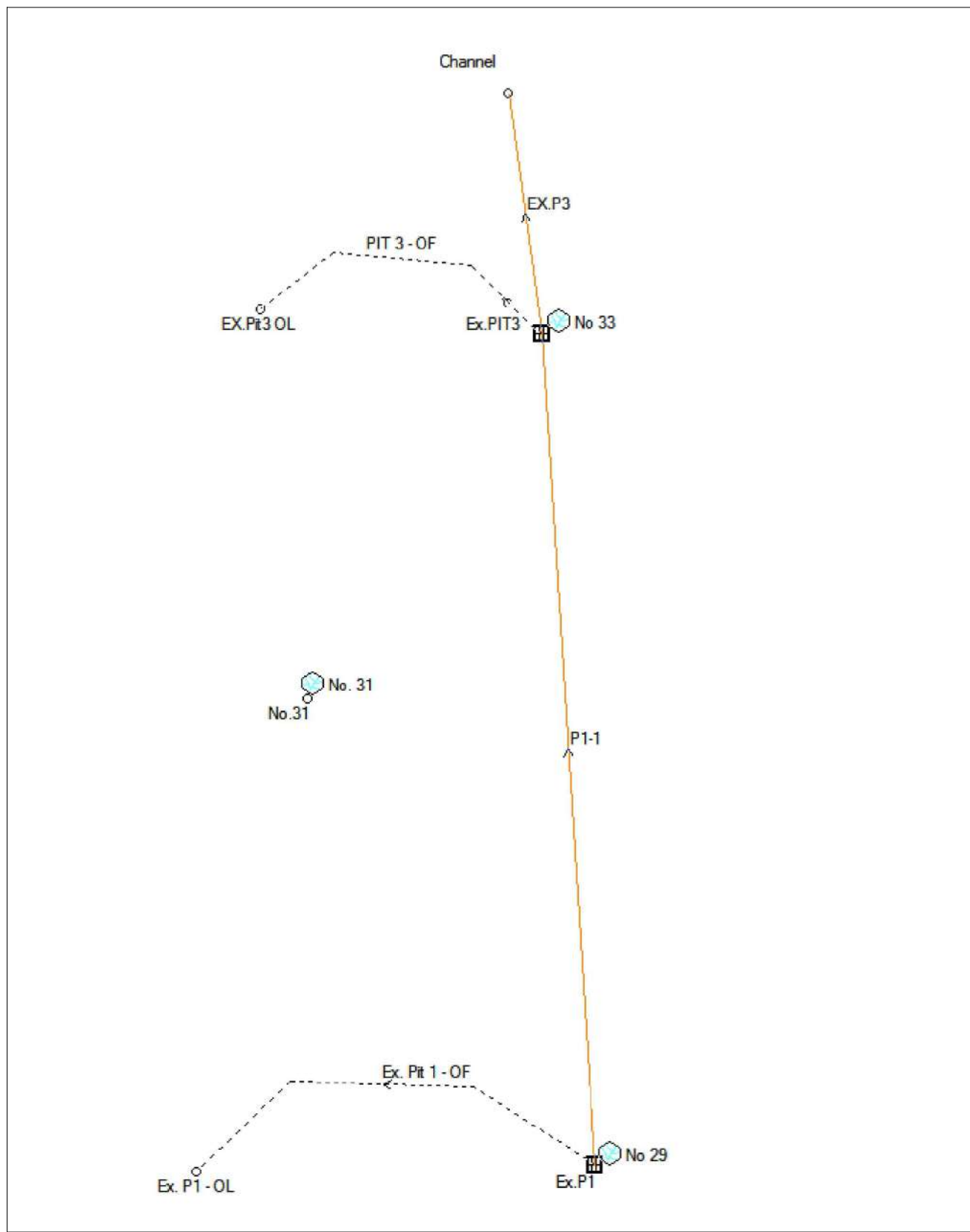

EXISTING STORMWATER DRAINS LAYOUT  
NTS

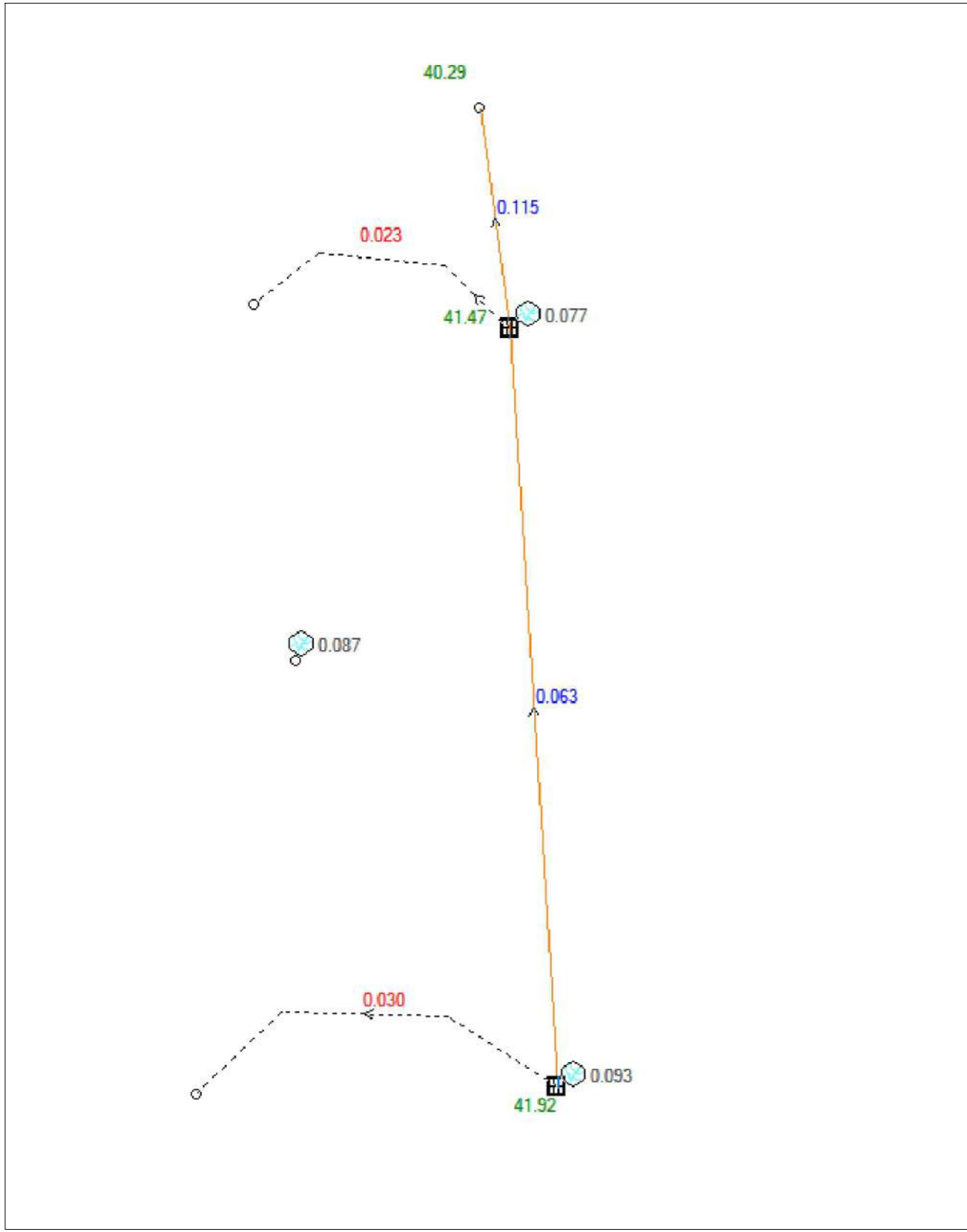

EXISTING 100YEAR ARI DRAINS RESULTS  
NTS

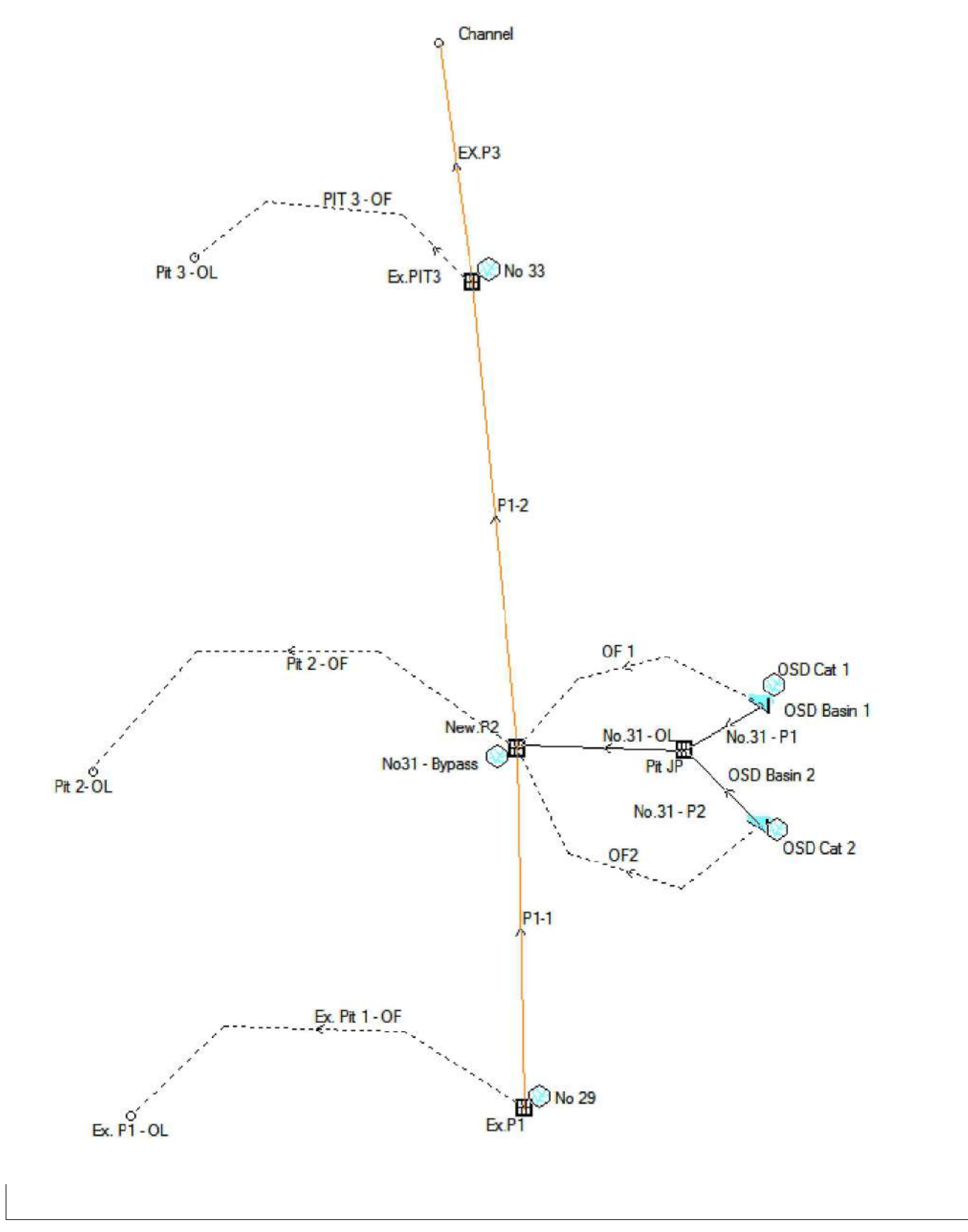

PROPOSED STORMWATER DRAINS LAYOUT  
NTS

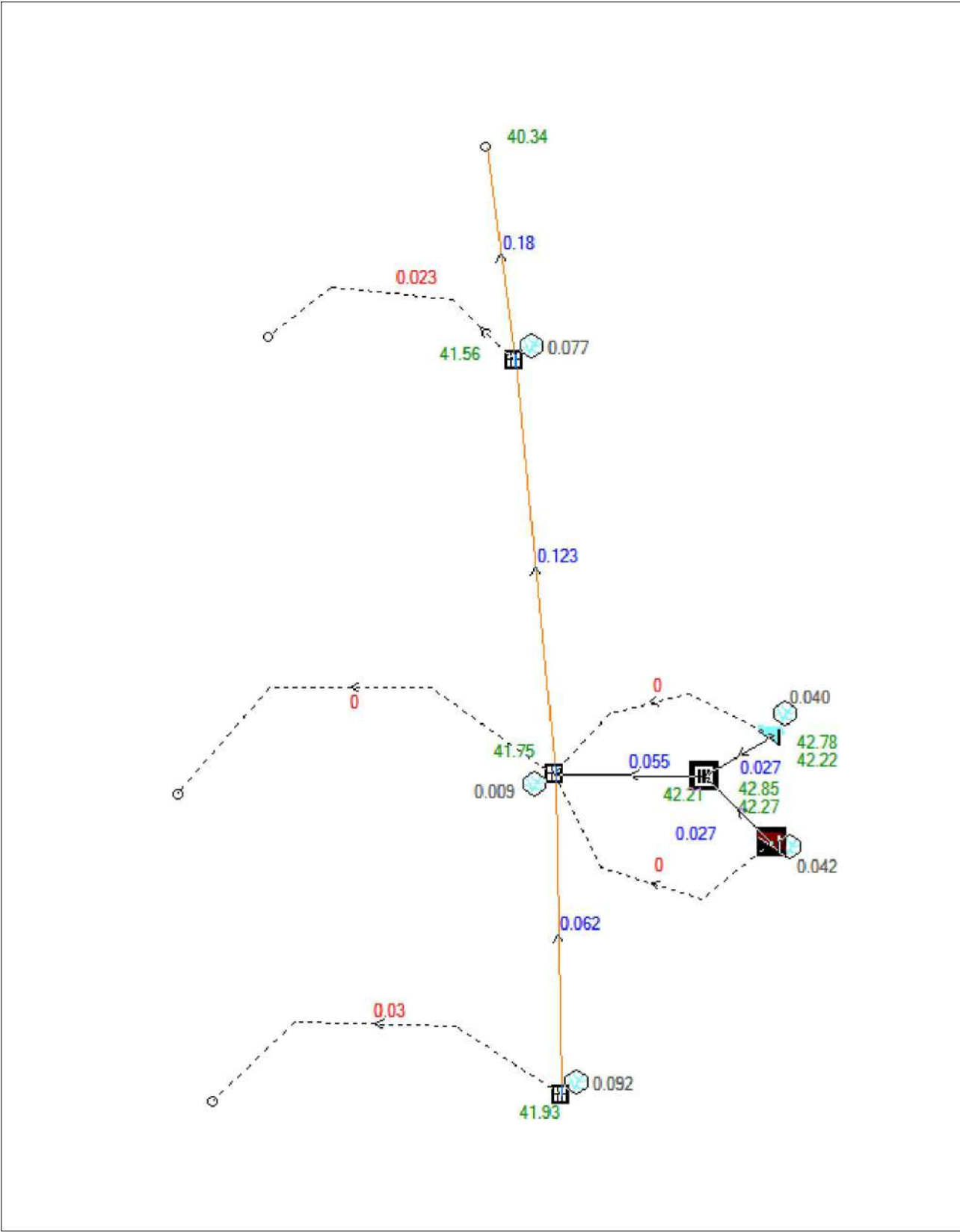

PROPOSED 100YEAR ARI DRAINS RESULTS  
NTS



ISSUE	REVISION	DATE

REFERENCE COORDINATION DRAWING							
DISCIPLINE	DRAWING TITLE AND NUMBER	DATE	REV.		DRAWING TITLE AND NUMBER	DATE	REV.
ARCH.				FIRE			
STRUCT.				LANDS			
MECH.				CIVIL			
ELEC.				SURVEY			
HYD.							

**GENERAL NOTES :**

- THIS DRAWING IS THE COPYRIGHT OF NASTASI & ASSOCIATES CONSULTING CIVIL & STRUCTURAL ENGINEERS, Unit 5,1-3 Whyalla Place,Prestons, 2170. PO Box 6048, Hammondville, NSW, 2170.
- IT IS NOT ALLOWED TO COPY OR REPRODUCE ITS CONTENTS IN ANY FORM EXCEPT FOR THE PURPOSE WHICH IT IS INTENDED WITHOUT THE ABOVE CONSULTANTS AUTHORITY.
- DO NOT SCALE THIS DRAWING, ONLY STATED DIMENSIONS ARE TO BE CONSIDERED.
- CONTRACTOR TO VERIFY THE DETAIL / INFORMATION GIVEN IN THIS DRAWING, ANY DISCREPANCIES SHALL BE BROUGHT TO ENGINEERS ATTENTION PRIOR TO COMMENCEMENT OF WORK, FAILURE TO COMPLY WITH THE ABOVE WILL BE CONTRACTORS LIABILITY.

**NASTASI & ASSOCIATES**  
CONSULTING CIVIL & STRUCTURAL ENGINEERS  
B.E., M.I.E. AUST. CPENG NPER-3  
ABN 45 633 226 008  
UNIT 5, 1-3 WHYALLA PLACE, PRESTONS NSW 2170  
PH: (02) 9607 2864 OR (02) 8798 8617 FAX: (02) 9731 2081  
MOB: 0419 041 401

QUALITY CONTROL	
DRAWN	DATE
DESIGNED	DATE
CHECKED	DATE

APPROVED:
-----------

CLIENT:
PROJECT:

TITLE:
DRAINS MODEL RESULTS

DRAWING STATUS CONCEPT PLAN FOR APPROVAL		
SCALE ( AT ORIGINAL SIZE) AS NOTED		
PROJECT NO.	DRAWING NO.	REVISION NO.
	C4	



HEAD = 5.00 m  
PROVIDE TWO AUTO SUBMERSIBLE PUMP KS-20 APPROVED EQUIVALENT  
ALTERNATIVE OPERATING AND PUMPING 6.12 l/s

- THE PUMPS SHALL BE PROGRAMMED TO WORK ALTERNATIVELY SO AS TO ALLOW BOTH PUMPS TO HAVE AN EQUAL OPERATION LOAD AND PUMP LIFE.
- A LOW LEVEL FLOAT SHALL BE PROVIDED TO ENSURE THAT THE MINIMUM REQUIRED WATER LEVEL IS MAINTAINED WITHIN THE SUMP AREA OF THE BELOW GROUND TANK. IN THIS REGARD THIS FLOAT WILL FUNCTION AS AN OFF SWITCH FOR THE PUMPS.
- A SECOND FLOAT SHALL BE PROVIDED AT A HIGHER LEVEL, APPROXIMATELY 300mm ABOVE THE MINIMUM WATER LEVEL, WHEREBY ONE OF THE PUMPS WILL OPERATE AND DRAIN THE TANK TO THE LEVEL OF THE LOW-LEVEL FLOAT.
- A THIRD FLOAT SHALL BE PROVIDED AT A HIGH LEVEL WHICH IS APPROXIMATELY THE SAME LEVEL AS THE BELOW GROUND TANK. THIS FLOAT SHOULD START THE OTHER PUMP IF THE LOW LEVEL IS NOT MAINTAINING AN ACTIVE WATER LEVEL.
- AN ALARM SYSTEM SHALL BE PROVIDED WITH A FLASHING STROBE LIGHT AND A PUMP FAILURE WARNING SIGN WHICH ARE TO BE LOCATED AT THE DRIVEWAY ENTRANCE TO THE BASEMENT LEVEL. THE ALARM SYSTEM SHALL BE PROVIDED WITH A BATTERY BACK-UP IN CASE OF POWER FAILURE.



- BASEMENT SLAB TO HAVE 1% MIN. FALL TO INLET PIT AS PER AS2890 REQUIREMENT
- ALL BASEMENT PIT TO BE FITTED WITH HEAVY DUTY CLASS C GRATE & FRAME
- PIPE PENETRATION THROUGH BASEMENT WALL TO BE FULLY SEALED AND HAVE PUDDLE FLANGE (TYP.)

REFERENCE COORDINATION DRAWING							
DISCIPLINE	DRAWING TITLE AND NUMBER	DATE	REV.		DRAWING TITLE AND NUMBER	DATE	REV.
ARCH.				FIRE			
STRUCT.				LANDS			
MECH.				CIVIL			
ELEC.				SURVEY			
HYD.							

\* THIS DRAWING IS THE COPYRIGHT OF NASTASI & ASSOCIATES CONSULTING CIVIL & STRUCTURAL ENGINEERS,  
Unit 5/1-3 Myholio Place, Prestons, 2170. PO Box 6048, Hammondville, NSW, 2170.

\* IT IS NOT ALLOWED TO COPY OR REPRODUCE ITS CONTENTS IN ANY FORM EXCEPT FOR THE PURPOSE  
WHICH IT IS INTENDED WITHOUT THE ABOVE CONSULTANT'S AUTHORITY.

\* DO NOT SCALE THIS DRAWING, ONLY STATED DIMENSIONS ARE TO BE CONSIDERED.

\* CONTRACTOR TO VERIFY THE DETAIL / INFORMATION GIVEN IN THIS DRAWING, ANY DISCREPANCIES SHALL  
BE BROUGHT TO ENGINEERS ATTENTION PRIOR TO COMMENCEMENT OF WORK, FAILURE TO COMPLY WITH THE  
ABOVE WILL BE CONTRACTORS LIABILITY.



APPROVED:

PROJECT:

BASEMENT DRAINAGE PLAN

AS NOTED

DRAWING NO.

REVISION NO.



**www.dialbeforeyoudig.com.au**







F  
E  
D  
C  
B  
A

F  
E  
D  
C  
B  
A

a1

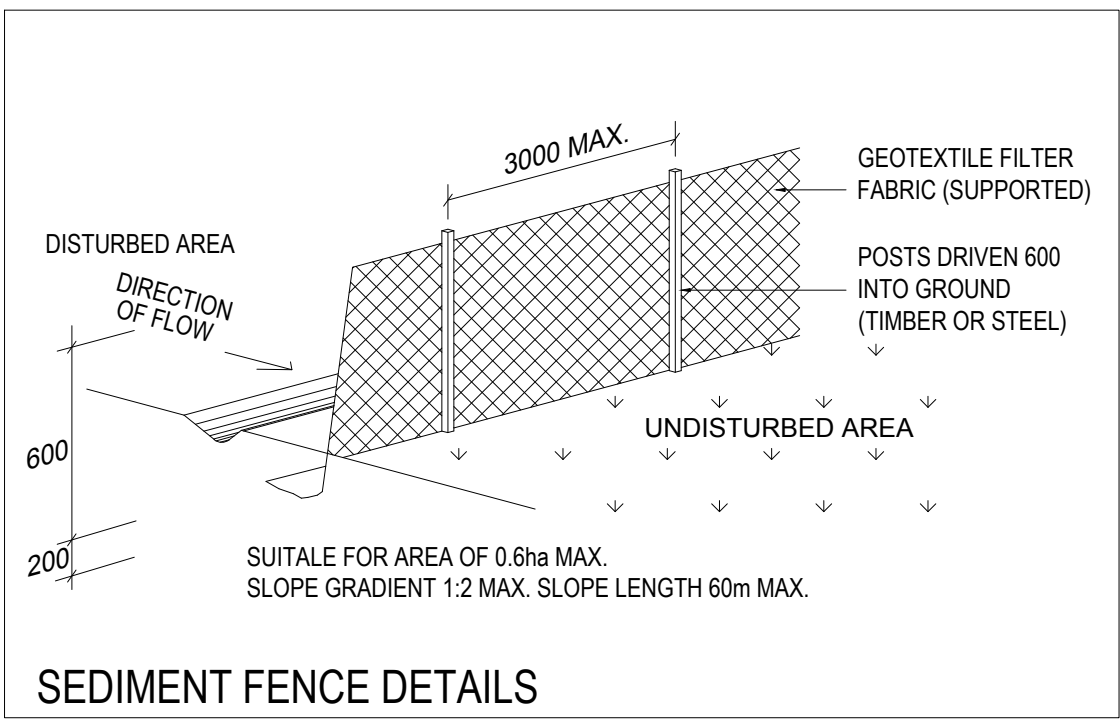
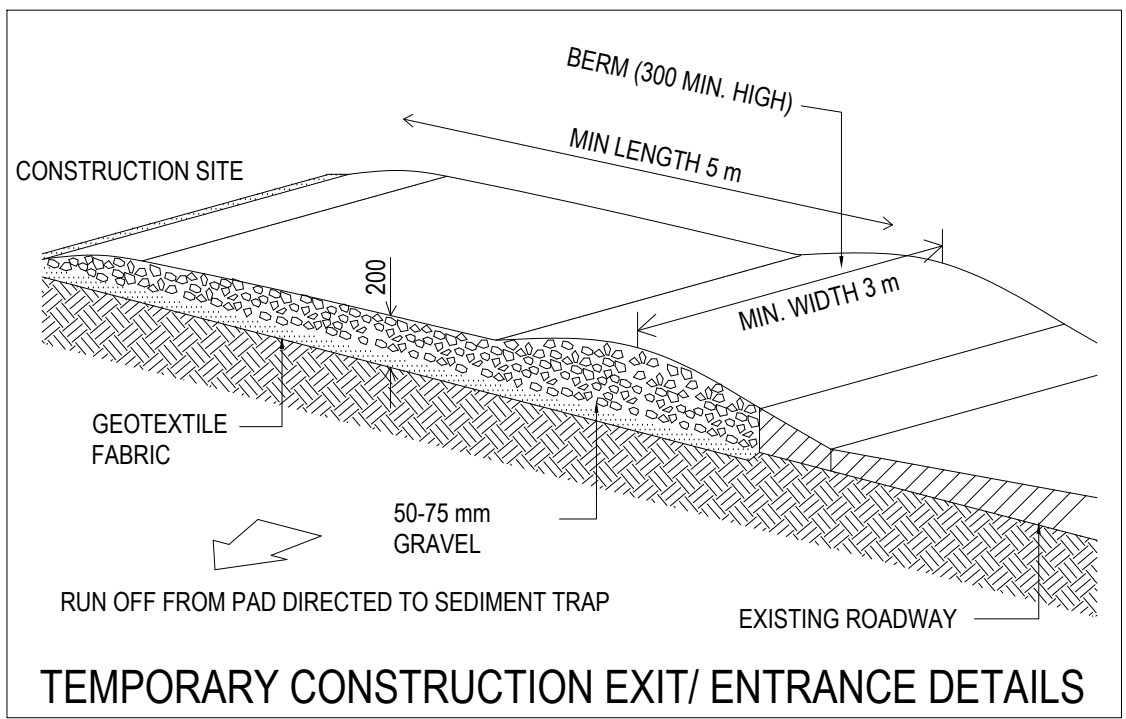
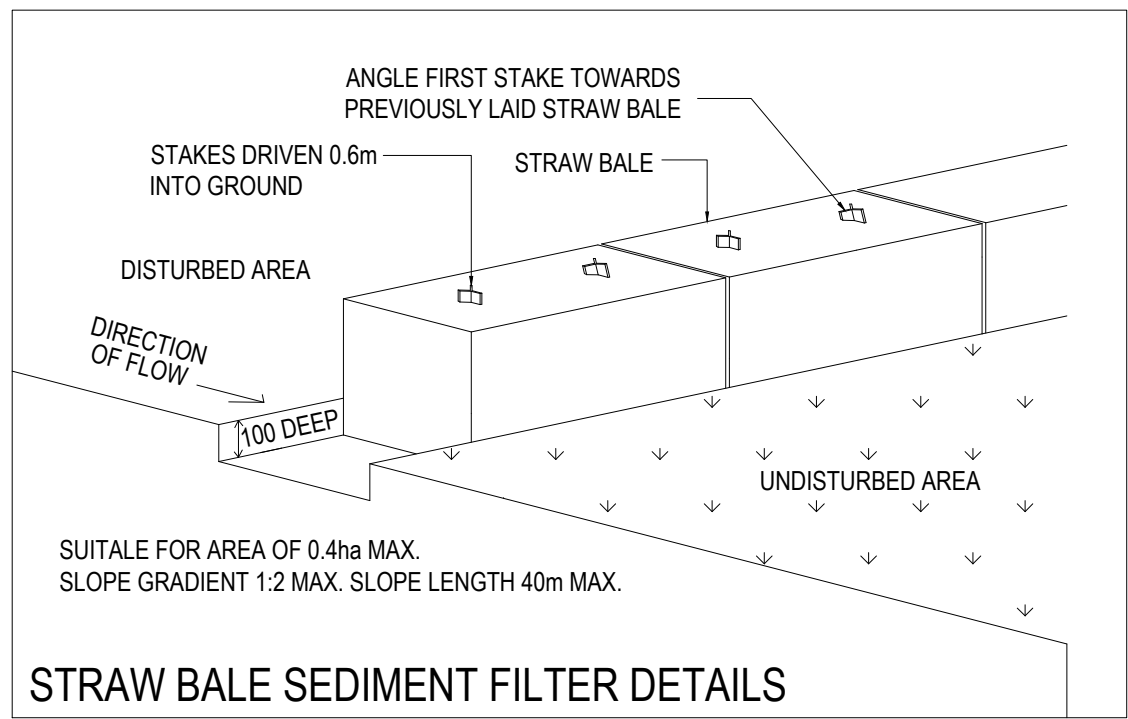
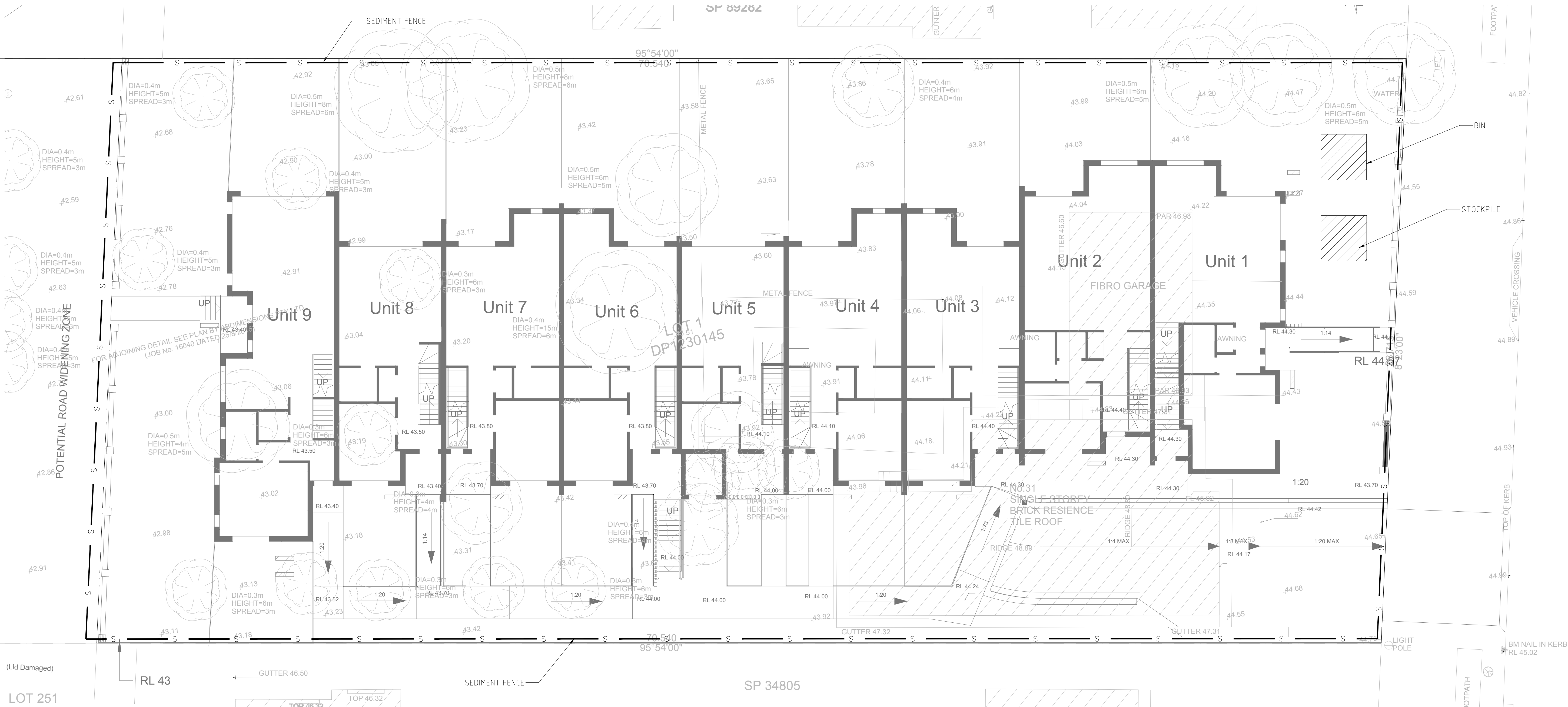

- NOTES**
1. ALL EROSION AND SEDIMENT CONTROL MEASURES TO BE INSPECTED AND MAINTAINED DAILY BY SITE MANAGER
  2. MINIMISE DISTURBED AREA
  3. ALL STOCKPILES TO BE CLEAR FROM DRAINS, GUTTERS AND FOOTPATH
  4. DRAINAGE IS TO BE CONNECTED TO STORMWATER SYSTEM AS SOON AS POSSIBLE
  5. ROADS AND FOOTPATH TO BE SWEEPED DAILY
  6. KERB SIDE INLET TO BE PROTECTED WITH FABRIC FILLED WITH GRAVEL
  7. NON-COMPLIANCE MAY INCUR PENALTY

ISSUE FOR APPROVAL



REFERENCE COORDINATION DRAWING				DRAWING TITLE AND NUMBER			
DISCIPLINE	DRAWING TITLE AND NUMBER	DATE	REV.	DRAWING TITLE AND NUMBER	DATE	REV.	
ARCH.				FIRE			
STRUCT.				LANDS			
MECH.				CIVIL			
ELEC.				SURVEY			
HYD.							
ISSUE	REVISION	DATE					

**GENERAL NOTES :**

- THIS DRAWING IS THE COPYRIGHT OF NASTASI & ASSOCIATES CONSULTING CIVIL & STRUCTURAL ENGINEERS, Unit 5,1-3 Whyalla Place,Prestons, 2170, PO Box 6048, Hammondville, NSW, 2170.
- IT IS NOT ALLOWED TO COPY OR REPRODUCE ITS CONTENTS IN ANY FORM EXCEPT FOR THE PURPOSE WHICH IT IS INTENDED WITHOUT THE ABOVE CONSULTANTS AUTHORITY.
- DO NOT SCALE THIS DRAWING, ONLY STATED DIMENSIONS ARE TO BE CONSIDERED.
- CONTRACTOR TO VERIFY THE DETAIL / INFORMATION GIVEN IN THIS DRAWING, ANY DISCREPANCIES SHALL BE BROUGHT TO ENGINEERS ATTENTION PRIOR TO COMMENCEMENT OF WORK, FAILURE TO COMPLY WITH THE ABOVE WILL BE CONTRACTORS LIABILITY.

**NASTASI & ASSOCIATES**  
CONSULTING CIVIL & STRUCTURAL ENGINEERS  
B.E., M.I.E. AUST. CPENG NPER-3  
ABN 45 533 226 008  
UNIT 5, 1-3 WHYALLA PLACE, PRESTONS NSW 2170  
PH: (02) 9607 2884 OR (02) 9798 9617 FAX: (02) 9731 2081  
MOB: 0419 041 401

QUALITY CONTROL		APPROVED:	CLIENT:
DRAWN	DATE		
DESIGNED	DATE		
CHECKED	DATE		

PROJECT:

TITLE:

SEDIMENT CONTROL PLAN & DETAILS

DRAWING STATUS		
CONCEPT PLAN FOR APPROVAL		
SCALE ( AT ORIGINAL SIZE)		AS NOTED
PROJECT NO.	DRAWING NO.	REVISION NO.
	C7	

1

2

3

4

5

6

7

8